

PLAN OF PROPOSED SUBDIVISION IN PLOT A5 IN LA 166/72 DHANDAYUTHAPANI NAGAR, KOTTURPURAM, TS No.2 OF BLOCK 14 AND TS No.6 OF BLOCK 16 - ADYAR

PLOT A5

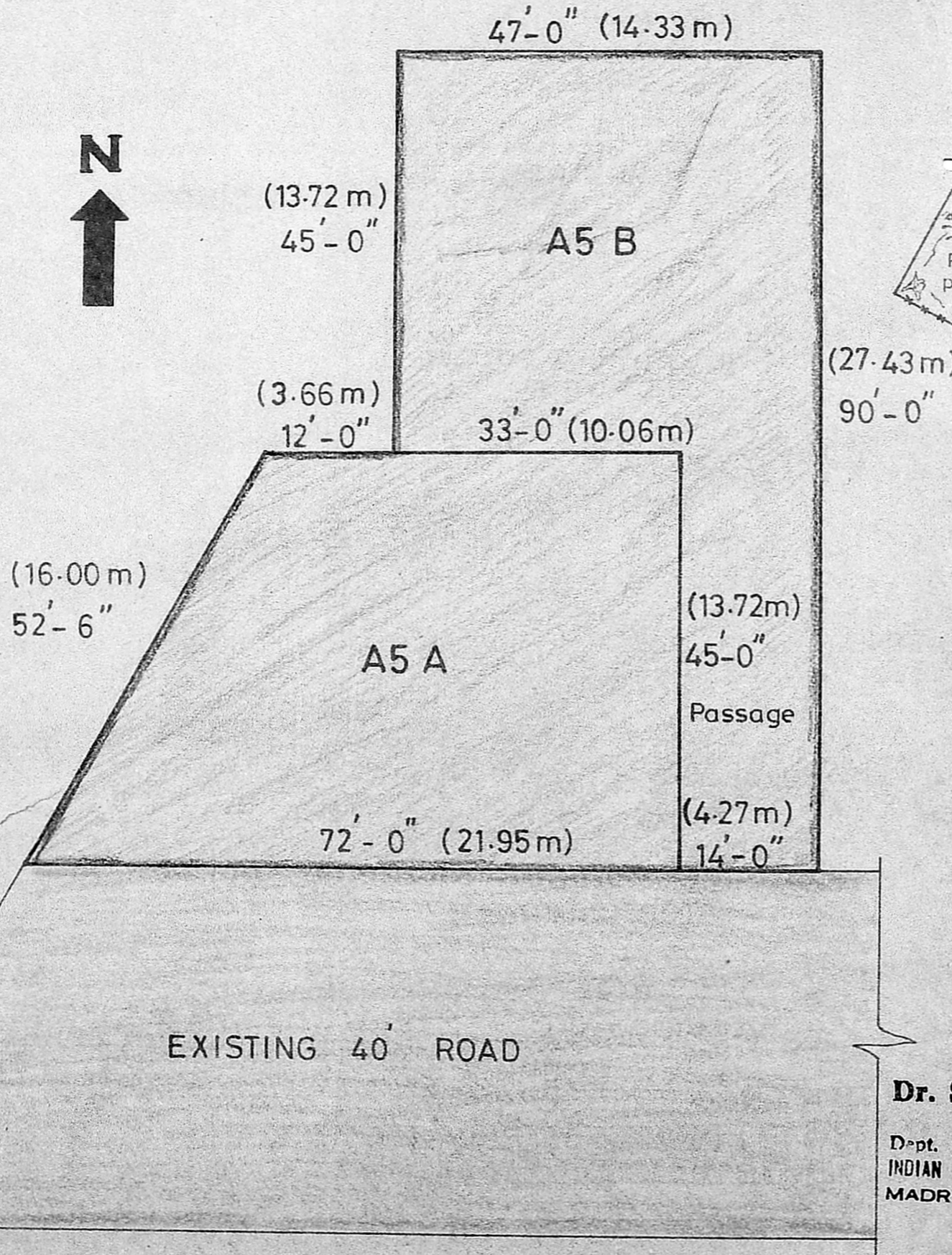

SITE PLAN

Scale: 1" = 16 ft (1:200)

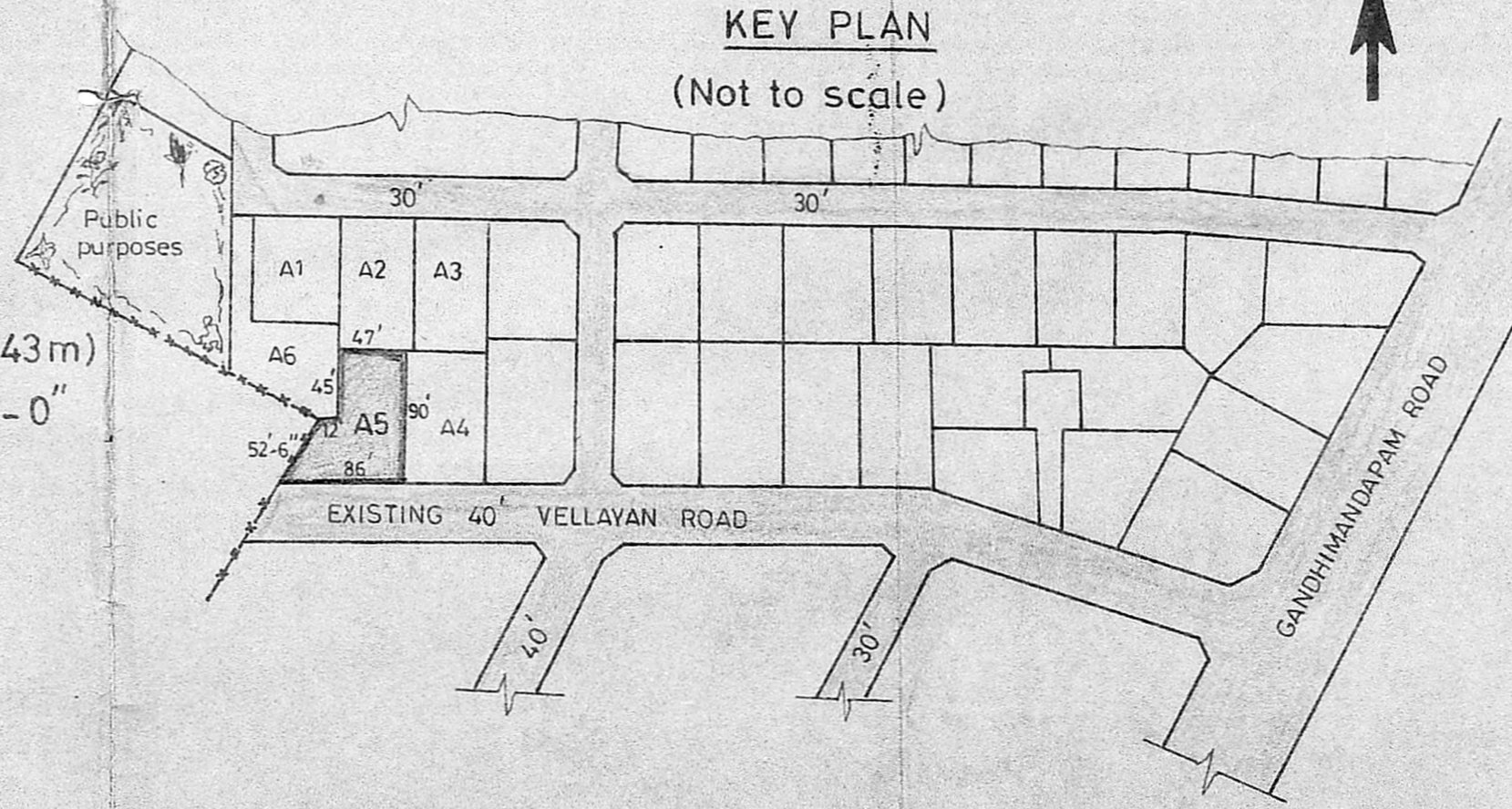

KEY PLAN
(Not to scale)

DETAILS OF SUBDIVISION OF PLOT A5 INTO A5A AND A5B

PLOT A5A	=	2633 sq.ft (244.61 sq.m)
PLOT A5B	=	2115 sq.ft (196.49 sq.m)
Passage	=	630 sq.ft (58.53 sq.m)
Total	=	2 G,0578 sq.ft (499.63 sq.m)

APPROVED
VIDE Lr. No. D2(L)/1476/89
Dtd.....3.....89

S. Krishnan
Dr. S. KRISHNAN
PROFESSOR
Dept. of Aeronautical Engg.
INDIAN INSTITUTE OF TECHNOLOGY
MADRAS-600096 INDIA

COLOUR CODE
 [Red Box] RED PROPOSED
 [Green Box] GREEN ROAD
 [Black Box] BLACK BOUNDARY

[Signature]
Licensed surveyor
B. S. S. S. N. B. C. E.
Consulting Professor &
Licensed Surveyor
Corporation of Madras
Licence No. 24
No. 15, Bhuvaneshwaram Road
T. NAGAR, MADRAS-600017

P.P. D...
No: 51
89
L.d
FOR MEMBER SECRETARY
MADRAS METROPOLITAN
DEVELOPMENT AUTHORITY

[Signatures]
7/13/89
Ch
B.S.S.